

1.25mm .049" Center Wire to Board Connector



1251 Series

■ TERMINAL

- Part No.: 1251-T-T-S
- Material: Phos. bronze
- Thickness: 0.15mm
- Plating: Tin plated
- Wire Range: Suitable for AWG#28~32
- Insulation O.D: 0.90mm (max)
- Q'TY: 10,000 pcs/reel
- Accepts housing : 1251-H

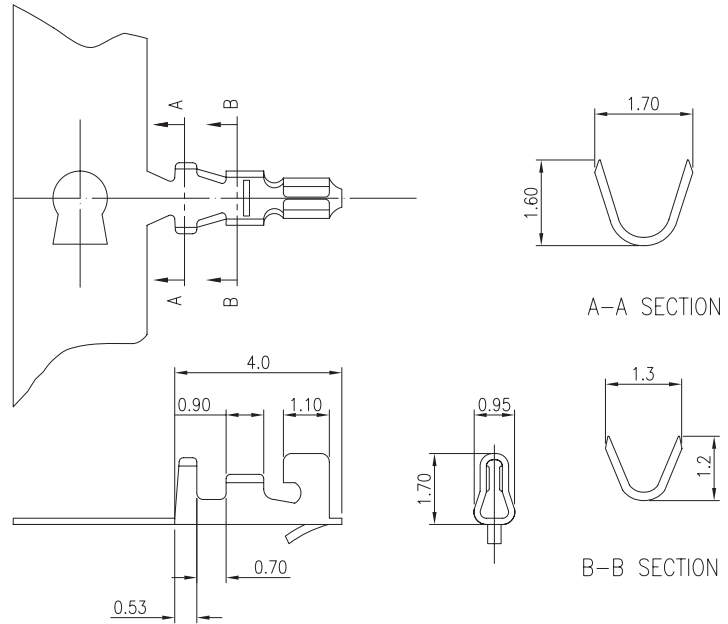

Ordering Information

| Part No. | Wire Range | Insulation O.D. | Material | Finish | Q'ty/reel | Note |
|------------|-------------|-----------------|--------------|------------|------------|------|
| 1251-T-T-S | AWG #28~#32 | 0.90mm (max) | Phos. bronze | Tin Plated | 10,000 pcs | |

1251 Series

■ HOUSING

- Part No.: 1251-H
- Material: Nylon 66, UL94V-0
- Pitch: 1.25mm (.049")
- Poles: 2~15
- Q'TY: 1,000 pcs/bag
- Accepts terminals : 1251-T-T-S

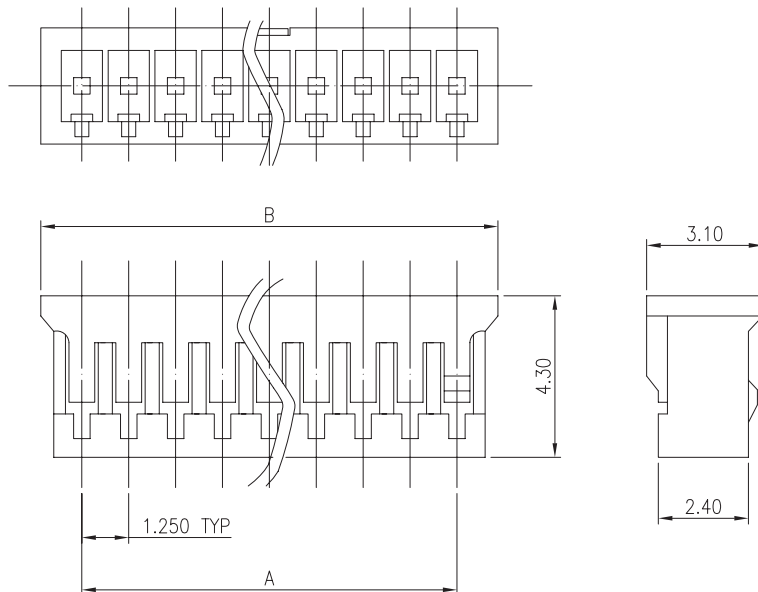
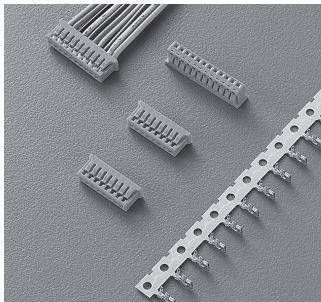

Ordering Information and Dimensions

| CIRCUITS | PART NO. | DIMENSION | |
|----------|------------|-----------|-------|
| | | A | B |
| 2 | 1251-H-02P | 1.25 | 3.95 |
| 3 | 1251-H-03P | 2.50 | 5.20 |
| 4 | 1251-H-04P | 3.75 | 6.45 |
| 5 | 1251-H-05P | 5.00 | 7.70 |
| 6 | 1251-H-06P | 6.25 | 8.95 |
| 7 | 1251-H-07P | 7.50 | 10.20 |
| 8 | 1251-H-08P | 8.75 | 11.45 |

| CIRCUITS | PART NO. | DIMENSION | |
|----------|------------|-----------|-------|
| | | A | B |
| 9 | 1251-H-09P | 10.00 | 12.70 |
| 10 | 1251-H-10P | 11.25 | 13.95 |
| 11 | 1251-H-11P | 12.50 | 15.20 |
| 12 | 1251-H-12P | 13.75 | 16.45 |
| 13 | 1251-H-13P | 15.00 | 17.70 |
| 14 | 1251-H-14P | 16.25 | 18.95 |
| 15 | 1251-H-15P | 17.50 | 20.20 |