

# 2.5mm .098" Center Wire to Board Connector



## 2520 Series

### ■ TERMINAL

- Part No.: 2520-T-T-S
- Material: Phos. bronze
- Thickness: 0.2mm
- Plating: Tin plated 60u"
- Wire Range: Suitable for AWG#24~28
- Insulation O.D: 1.80mm (max)
- Q'TY: 10,000 pcs/reel
- Accepts housing : 2520-H

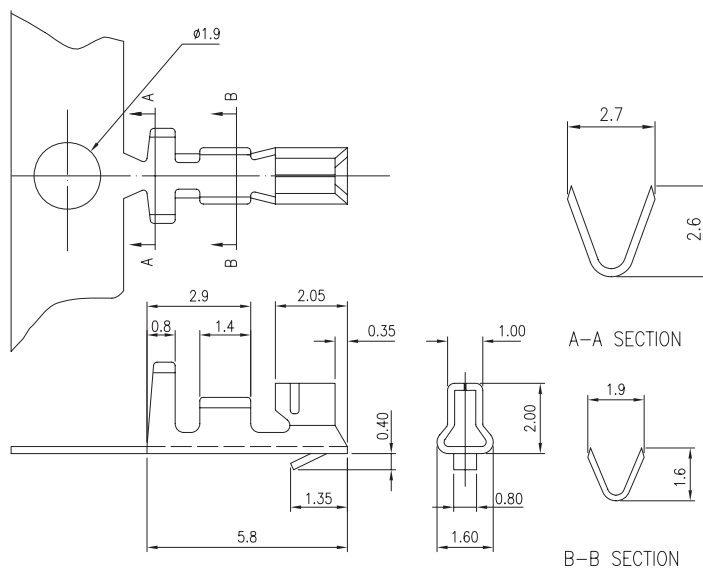

### Ordering Information

Part No.	Wire Range	Insulation O.D.	Material	Finish	Q'ty/reel
2520-T-T-S	AWG #24~#28	1.80mm (max)	Phos. bronze	Tin Plated	10,000 pcs

## 2520 Series

### ■ HOUSING

- Part No.: 2520-H
- Material: Nylon 66, UL94V-2
- Pitch: 2.5mm (.098")
- Poles: 2~15
- Q'TY: 1,000 pcs/bag
- Accepts terminals : 2520-T-T-S

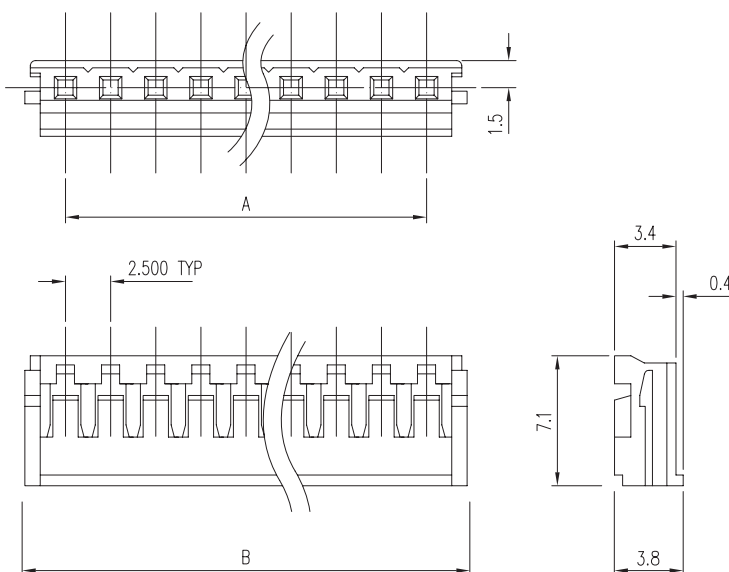
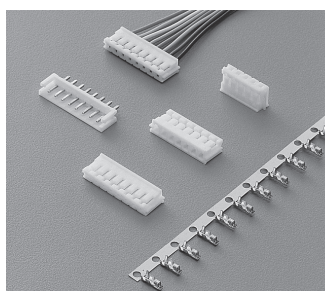

### Ordering Information and Dimensions

CIRCUITS	PART NO.	DIMENSION	
		A	B
2	2520-H-02P	2.50	7.0
3	2520-H-03P	5.00	9.5
4	2520-H-04P	7.50	12.0
5	2520-H-05P	10.00	14.5
6	2520-H-06P	12.50	17.0
7	2520-H-07P	15.00	19.5
8	2520-H-08P	17.50	22.0

CIRCUITS	PART NO.	DIMENSION	
		A	B
9	2520-H-09P	20.00	24.5
10	2520-H-10P	22.50	27.0
11	2520-H-11P	25.00	29.5
12	2520-H-12P	27.50	32.0
13	2520-H-13P	30.00	34.5
14	2520-H-14P	32.50	37.0
15	2520-H-15P	35.00	39.5